

BLACK LEGEND S



Builder : Mylius Yacht
Architect : Alberto Simeone
Designer : Mylius Yacht
Type : Cruiser-racer
Year : 2013
Lying : Monaco
Flag : Malta
Price : 1.200.000 € (VAT paid)

COMMENTS : Black Legend S is arguably one of the highest-specified Mylius ever prepared. Built in 2013 and bought in 2017 by it's current owner, Black Legend S is now known by her design and elegance in the mediterranean sea. She had a complete refit and upgrade, following a maintenance at the highest level by her professional crew and dedicated Owner.

Combining confort and performance, she has been prepared in 2018 for her first race, involving no more than 12 professionals sailors from all over the world.

Classification : N/A

Construction : Carbon fibre and epoxy sandwich

***hull :** Carbon Fiber

***superstructure :** Carbon fiber

***deck :** Teak deck

Colour *hull : Black

***superstructure :** Black

***deck :** Teak deck

Cabins : 1 Master Cabin forward + 2 double guest cabins aft

Length overall : 18,23m

Maximum beam : 4,80m

Draft : 3,57m

Displacement : 17.232Kg

Keel : 6.200Kg

Spars :

Standing rigging : PBO

Running rigging : Dyneema

Furlers : Profurl cruising electric furling jib + EC6 racing headstay

Sails :

Sail area *upwind : 195 m²

***downwind:** 320 m²

Deck hardware :

Windlass : Lewmar 24vDC electric reversing anchor windlass

Bow Thruster : MaxPower 24vDC

Engine : Yanmar 4JH 110hp (new 2017), shaft drive gearbox (new 2017)

***Performances :** 9 knots

***Consumption :** 10L/hour

***Range :** 300nm

Generator Mastervolt WhisperPower 10kw (550 hours in August 2019)

Batteries 4 x Matservolt li-ion 24v for services

2 x Mastervolt AGM 24v for bow services (windlass, jib furler, bow-thruster)

1 x Matservolt AGM for engine start (2018)

1 x Mastervolt AGM for generator start (2018)

Fuel : 350 liters

Water : 600 liters

Boiler : Yes

Water maker : Schenker Ready Electron 60 (60L/hours)

Refrigerator : 2 front opening stainless steel fridge and freezer (new air-cooled compressor)
Deep freezer : Yes
Air-conditioning : Condaria 220v AC Reverse-cycle air conditioning
Heater : Yes, with Air Conditioning system

Electronic

- *instruments :** B&G H3000
- *sounder :** B&G
- *self steering :** B&G Autopilot
- *gyrocompass :** No
- *AIS :** NAIS 500 Class B
- *yacht monitoring :**
- *computer :** Azus PC computer
- *fleet 77 :** No
- *Iridium phone :** No
- *standard C :** No
- *mini M :** No
- *VHF radio :** Simrad RS12 DSC + 1 mobile

- *meteo :** C-Map expedition connected with 4G
- *GPS :** B&G integrated GPS
- *chart plotter :** B&G GPS Chart Plotter T12 + 2 B&G T9 at wheel stations
- *radar :** No
- *Epirb :** Yes
- *intercom :** No
- *stereo :** Bose system
- *TV systems :** Samsung smart TV 32" (model UE32ES6710Q)

DECK AND COCKPIT

B&G 20/20 displays at the mast
B&G H3000 displays in the cockpit
B&G autopilot display at wheel stations
B&G GPS charter plotter T9 at wheel stations
Steering compass

ACCOMMODATION

The salon features a galley on the port side, a chart table on the starboard, a table and a sofa leading to the master cabin forward.
Two guest cabins are located on each side aft of the yacht.

CHART TABLE

B&G GPS charter plotter T12
Marine PC with LCD screen
Mastervolt domotic system
Simrad RS12 VHF with DSC
Watermaker control panel
Generator control panel

SALOON

Sofa on the starboard side with white leather upholstery
Teak interior joinery
Teak flooring

CABINS

- 1 Master cabin ensuite with bathroom and separate shower
- 2 guest cabin with ensuite bathrooms and separate showers

SHOWER ROOM/HEAD

One shower + one toilet in each cabin's bathroom

GALLEY

- Stainless steel worktops
- Stainless steel gimbaled electric stove with 4 electric induction burners, oven and grill
- Miele microwave-oven combination
- 2 front opening stainless steel fridges and freezers (new air-cooled compressor)
- Sink with hot & cold pressurized supplies

DOMESTIC EQUIPMENT

COMMUNICATION EQUIPMENT

Wifi through 4G router

ENTERTAINMENT

- B&G Stereo system with Bose speakers
- Samsung smart TV 32" (model UE32ES6710Q)

CREW CABIN

1 crew bed in the forepeak

SAILS

Cruising Sails (painted logos): Northsails 3DL half-battened mainsail
Northsails 3DL furling jib
Northsails 3Di full battened mainsail
Northsails 3Di strap horizontal battened furling jib
Northsails V serie asymmetric A1-A2
Northsails Code 0

Racing sails (logos removable stickers): Northsails 3Di half battened mainsail (2018)
Northsails 3Di J1, J2, J3, J4 (2018)
Northsails V serie A1 & A2
Northsails 3Di Code 0
Northsails spinnaker staysail

RIGGING

PBO standing rigging (new D1/D2 in 2017, new PBO V1 2018, new PBO backstay 2017)
EC6 heafstay (new 2018)

DECK EQUIPMENTS:

Southern Spars carbon fibre mast paint in black and boom lacquered carbon finish Keel-stepped fractionally-rigged mast with 2 sets of swept-back spreaders

Navtec hydraulics for hydraulic controls: backstay, outhaul, traveller, vang Harken batten-car track for mainsail with ball-bearing batten-cars

Harken mainsheet traveller

Recessed self taking jib track

24vDC Profurl electric genoa furler – motor replaced may 2017).

Winches

2 x 55.3 ST Carbon fibre electric Harken control winches forward of helm 2 x 990.3 ST Carbon fibre electric Harken main sheet

2 x 65.3 ST Carbon fibre electric Harken halyards

ELECTRICITY

Charging / Inverter:

Mastervolt Mass Combi 24vDC charger with inverter

Generator:

Mastervolt WhisperPower 10kw generator Engine hours – approx. 550 hours as of August 2019 Last service (March 2019)

Alternators:

1 x 12vDC engine-mounted alternator for start batteries

1 x 24vDC engine-mounted alternator for services batteries

SAFETY AND SECURITY

Iperb

3 powder extinguisher + 1 in engine room

Flares package

Liferaft

Life jackets x 8

PLUMBING AND TANKS

Fuel: 350 litres capacity + daily tank

Fresh Water: 600 litres capacity

Holding tanks: 3 x black water holding tanks

MOORING

Lewmar 24v DC electric reversing anchor windlass (New 2018)

Sanguini retractable electric mooring windlass (new 2018)

Anchor and chain

Recessed mooring cleats/fenders and warps

TENDERS AND TOYS

2;6m inflatable tender with 9.9hp outboard

REFIT

- 2017-18: New paint hull and deck
- Full rig service + new paint
- New generator
- New engine
- Hydraulic systems(new hydraulic motor)
- New windlass
- New PBO backstay + EC6 headstay
- New VHF
- New steering cables
- 2020: New paint on deck coachroof

WORK TO BE DONE

None

VAT STATUS

VAT paid



























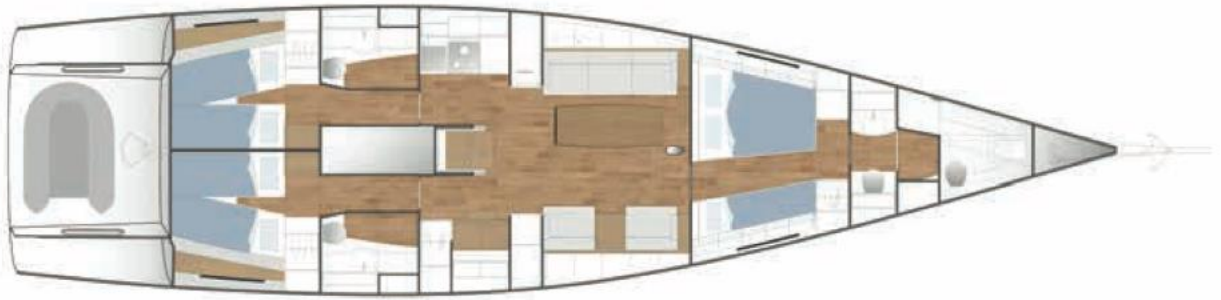
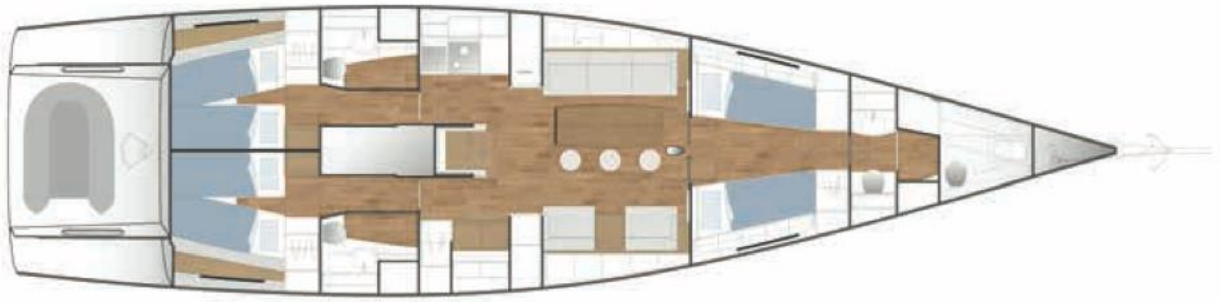

Detail given in good faith with no guarantee nor warrant for accuracy or conditions. A Buyer should instruct his surveyor to investigate such details as he desires validated. This is NOT a contractual document.